

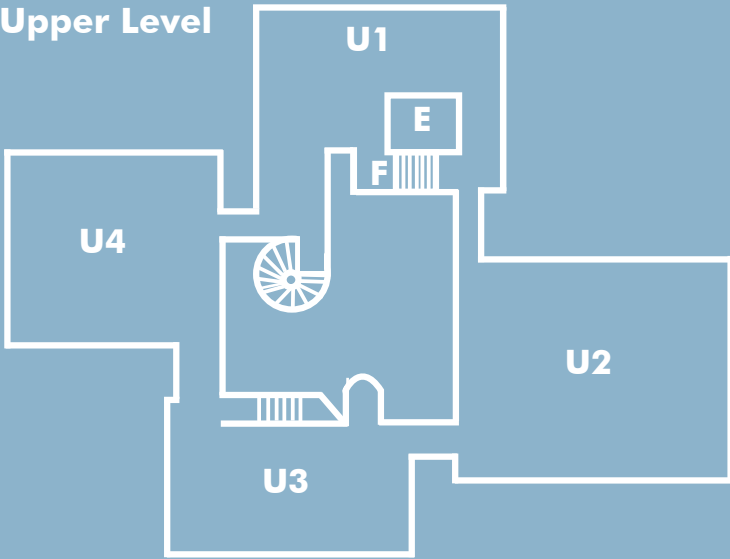

# VISITORS' GUIDE

## Upper Level



- U1 Coyne Gallery
- U2 Memorial Gallery
- U3 Falcone Gallery
- U4 Williams Gallery

- M1 Beadel Decorative Arts Center
- M2 Rosamond Gifford Sculpture Court
- M3 Museum Shop
- M4 Cloud Wampler Gallery
- M5 Robineau Memorial Gallery
- M6 Members' Council Gallery

- L1 Syracuse China Center for the Study of Ceramics
- L2 Hosmer Auditorium
- L3 Green Room
- L4 International Contemporary Ceramics
- L5 Art Zone
- L6 Administrative Offices
- L7 Hancock Gallery

- MR Mens Restroom
- LR Ladies Restroom
- HR Handicap Restroom
- E Elevator
- F Fire Exit

## Main Level

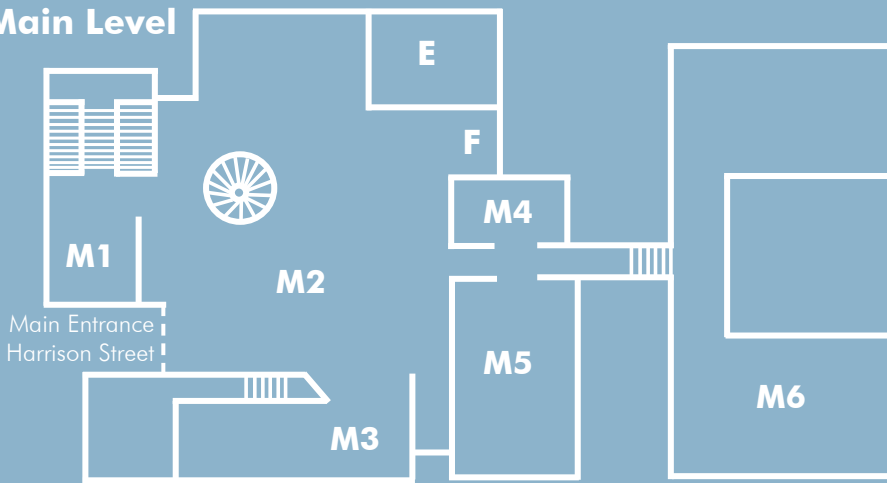

## Lower Level

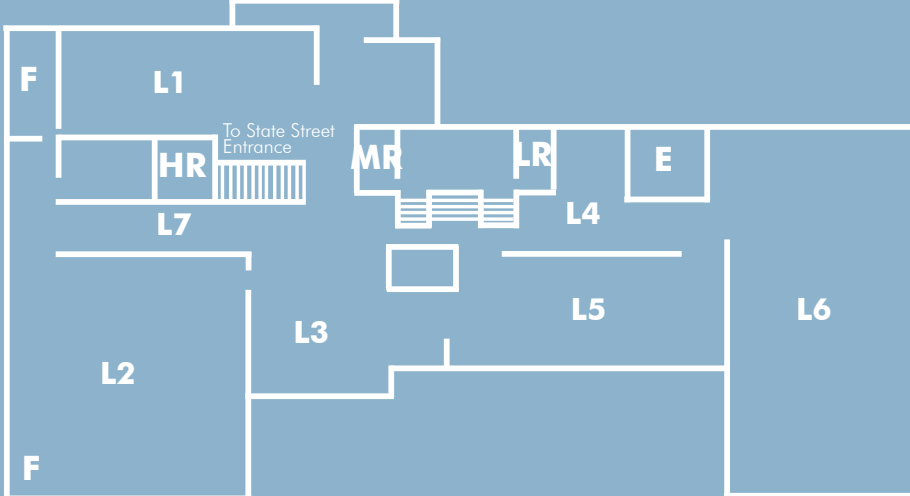

401 Harrison Street  
 Syracuse, NY 13202  
 (315) 474 6064  
 www.everson.org

### Admission

General admission to the galleries is free with a suggested donation of \$5 per person. Tickets are required for certain exhibitions, visit [everson.org](http://everson.org) for ticket information.

### Hours

Tuesday & Wednesday: noon - 6.00pm  
 Thursday & Friday: noon - 9.00pm  
 Saturday & Sunday: 9.00am - 6.00pm



EVERSON MUSEUM OF ART

# NOW ON VIEW

*Turner to Cézanne: Masterpieces from the Davies Collection, National Museum Wales*  
Through January 3, 2010  
Falcone, Memorial and Coyne Galleries, Second Level

*Women of Rookwood: The Joyce and Eliot Sterling Collection of American Art Pottery*  
Through January 31, 2010  
Cloud Wampler Gallery, Main Level

*Arts & Crafts of New York State*  
Through January 31, 2010  
Members' Council Gallery, Main Level

*The Syracuse China Collection*  
ongoing  
Beadel Decorative Arts Center, Main Level

## Museum Policies

- Food and beverage are not permitted inside the galleries.
- For the safety of the art & visitors, nothing may be carried on your back.
- Items that cannot be carried reasonably and safely must be stored in our lockers. For your convenience, we provide free tokens for the lockers that can be retrieved at either the Museum Shop or Welcome Desk.
- Children may not be carried on the shoulders of another person or in a backpack child carrier. Strollers are permitted inside the galleries.
- The Museum permits photography and videotaping of the permanent collection with permission from the Museum; loaned exhibitions may not be photographed or videotaped. Please see the receptionist in the administrative offices for permission to photograph the permanent collection.
- Do not approach any artwork closer than 24" or in any other way that will endanger it when photographing.
- No electronic flashes or tripods may be used in the Museum.